



TOSA-LC 10Gbps 1310nm DFB

Features:

- Low threshold current
- High bandwidth
- Operating temperature range $T_C = -40$ to $+85^\circ\text{C}$
- With optical isolator

Applications:

- 10G Gigabit Ethernet
- 10G Fiber Channel

Specifications:

Absolute Maximum Ratings:

Parameter	Symbol	Min	Max.	Unit
LD Reverse Voltage	$V_{r(LD)}$	--	2	V
LD Forward Current	$I_{f(LD)}$	--	120	mA
PD Forward Current	$I_{f(PD)}$	--	10	mA
PD Reverse Voltage	$V_{r(PD)}$	--	20	V
Operating Temperature	T_{op}	-40	85	
Storage Temperature	T_{stg}	-40	95	
Lead Solder Temperature	--	--	260	
Lead Soldering Time	--	--	10	s

Electro-Optical Characteristics:

Parameter	Symbol	Test Condition	Min	Typ	Max	Unit
Threshold Current	I_{th}	--	--	--	12	mA
Forward Voltage	V_f	$I_{op}=I_{th}+20\text{mA}$	--	1.3	1.6	V
Monitor Current(MPD)	I_m	$I_{op}=I_{th}+20\text{mA}$	100	--	1000	μA
Dark Current(MPD)	I_d	$V_r=5\text{V}$	--	--	100	nA
Optical Output Power	P_o	$I_{op}=I_{th}+20\text{mA}$	0.45	--	0.75	mW
Slope efficiency	SE	$I_{op}=I_{th}+20\text{mA}$	0.0225	--	0.0375	mW/mA
Central Wavelength	λ_c	$I_{op}=I_{th}+20\text{mA}$	1300	1310	1320	nm
Spectral Width , -20dB	$\Delta\lambda$	$I_{op}=I_{th}+20\text{mA}$	--	--	1	nm
Side-mode suppression Ratio	SMSR	$I_{op}=I_{th}+20\text{mA}$	30	--	--	dB
Rise/Fall Tim(20~80%)	T_r/T_f	--	--	--	45	ps
Tracking Error	TE	-40 ~85	-1.5	--	+1.5	dB



Mechanical Dimension and Pin Assignment:

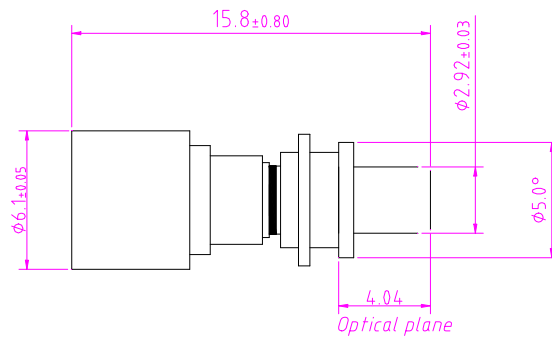



Statement:

SAN-U owns the authority for final explanation of all information contained in this document, which is subject to change without notice. All the information was obtained in particular environments; and SAN-U will not be responsible for the performance of the customers' actual operating environments. All information contained is only for the users' reference and shall not be considered as warranted characteristics. SAN-U will not be liable for damages arising directly or indirectly which from any use of the information contained in this document.

Contact Information:

Address: N501-505 Weiye Bldg., Xiamen Pioneering Park For Overseas Chinese Scholars, Xiamen, Fujian, China

Tel: +86-592-3898601, 3898608, 5318000

Fax: +86-592-5703588

Email: sales@san-u.com

<http://www.san-u.com>